

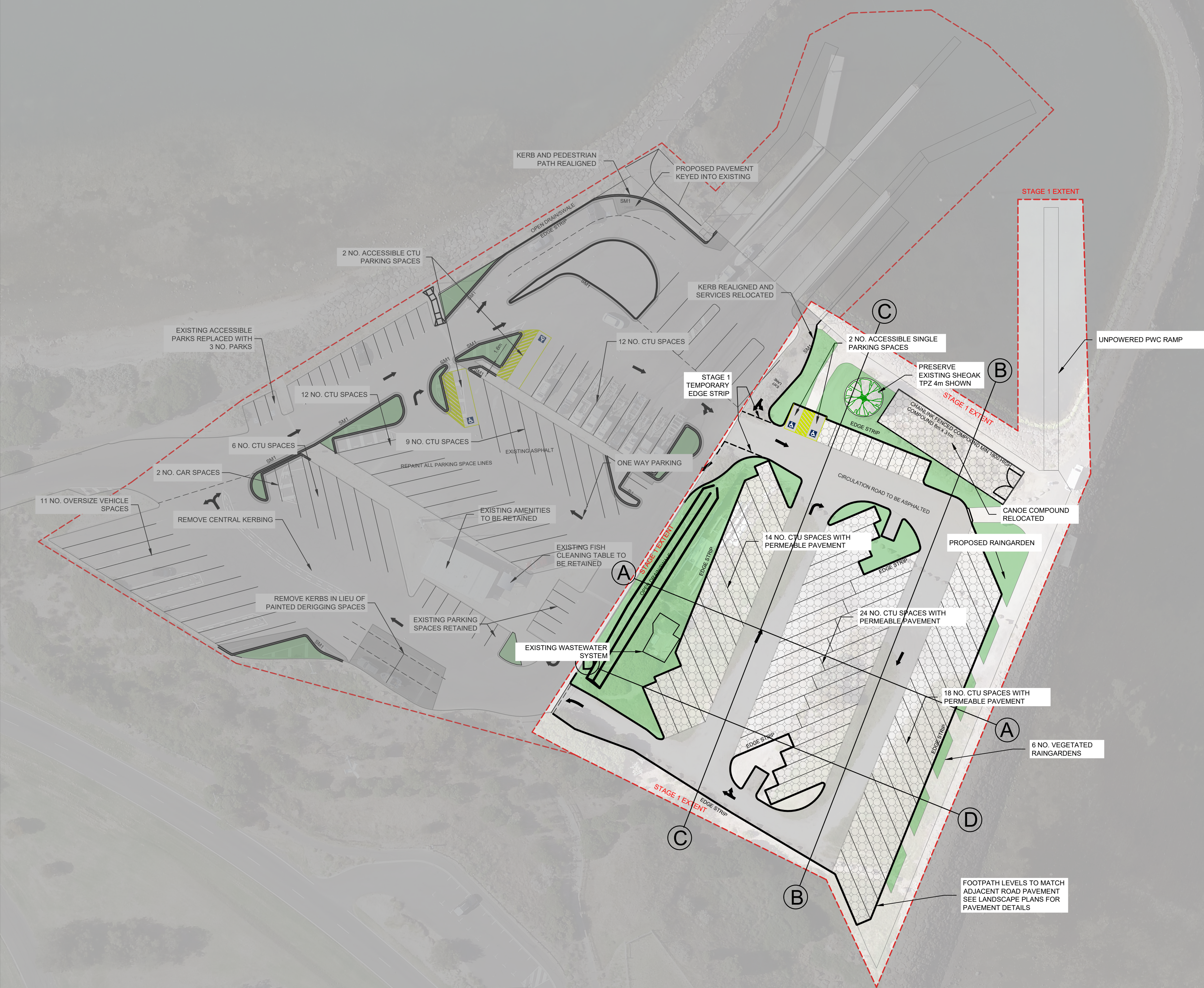

LEGEND

- LIMIT OF WORKS
- PROPOSED VEGETATION
- ▨ PROPOSED PERMEABLE PAVEMENT
- PROPOSED ASPHALT PAVEMENT
- PROPOSED BOLLARDS
- EXISTING LIGHTING
- SM1
EDGE STRIP TYPICAL KERB DETAILS (PER IDM)

- NOTES
- ALL DIMENSIONS ARE IN MILLIMETERS UNLESS NOTED OTHERWISE.
 - ALL COORDINATES ARE IN METERS RELATIVE TO THE GEOCENTRIC DATUM OF AUSTRALIA 2020 (GDA 2020) ZONE 55
 - ALL MATERIALS AND WORKMANSHIP WILL BE AS DEFINED IN THE SPECIFICATION UNLESS NOTED OTHERWISE.
 - EXISTING SERVICES LOCATIONS TO BE CONFIRMED WITH SERVICES SURVEY PRIOR TO CONSTRUCTION. SERVICES LOCATIONS ARE INDICATIVE ONLY AND MAY NOT BE RELIED ON FOR EXCAVATION, CUTTING AND DEMOLITION.



TENDER

P4	02/11/22	D2 - ISSUED FOR TENDER	TJD	GC	GC
P3	28/10/22	S1 - ISSUED FOR COMMENT	TJD	GC	GC
P2	13/10/22	S1 - ISSUED FOR COMMENT	TJD		TJD
P1	03/10/22	S1 - ISSUED FOR COMMENT	TJD		TJD
REV	DATE	DESCRIPTION	BY	CHK	APP

REVISIONS					
PROJECT LIMEBURNERS BOAT RAMP DESIGN					
CLIENT 					
BIM REF. WT-22010089-C-0004					
TITLE GENERAL ARRANGEMENT PLAN					
 15 Business Park Dr, Notting Hill VIC 3168 Tel +61 (0)3 8525 0800 Email info@watertech.com.au Website www.watertech.com.au					
DRAWN	TJD	CHECKED	GC	APPROVED	GC
DATE	NOV 2022	SCALE	AT A1	AS SHOWN	REF. 22010089-01-0004
DRAWING No.	WT-22010089-C-0004			SUITABILITY	REVISION
				D2	P4

ALL LEVELS ARE RELEVANT TO AUSTRALIAN HEIGHT DATUM (AHD) UNLESS OTHERWISE STATED.