

Queenscliff Boat Ramp Upgrade

May 2021

Better Boating Victoria is funding the delivery of the Queenscliff Boat Ramp upgrade. To minimise impact on the peak boating season, the project will be delivered in two stages.

Stage 1: Early June to Early September 2021

Stage 2: March – May 2022

Construction works are due to begin shortly for the Queenscliff Boat Ramp upgrade.

Better Boating Victoria is collaborating with the Borough of Queenscliff to deliver the upgrade to the Queenscliff Boat Ramp. A contract has been awarded and construction works will begin shortly. The boat ramp will be closed from Mid-June through to early September.



What's been happening?

Queenscliff Boating Facility is one of six priority boating facilities the government committed to upgrade as part of its unprecedented investment in recreational boating. Construction works will commence shortly on this popular regional boating destination.

The upgrade

The aim of the upgrade is to improve traffic flow and efficiency at which vessels can launch and retrieve. The upgrade will include:

- Addition of a third boat ramp lane
- Installation of central pontoon
- Replacement of existing floating pontoons and lengthened for increased capacity
- Dredging works to provide safe navigation
- Formalised overflow car parking area
- Updated lane system to improve circulation
- Installation of dedicated kayak launch ramp

Upcoming construction works

Construction works for the upgrade will be split into two stages to avoid impact on the peak boating season. Works include:

Stage 1: June to September 2021

Construction of overflow car parking area and civil works and dredging

Stage 2: March – May 2022

Installation of third boat ramp lane and central floating pontoon and final civil works in main carpark.

What's happening next?

Stage 1 works are due to commence in early June. Monthly updates will be provided on the Borough of Queenscliff's website: <https://www.queenscliff.vic.gov.au>

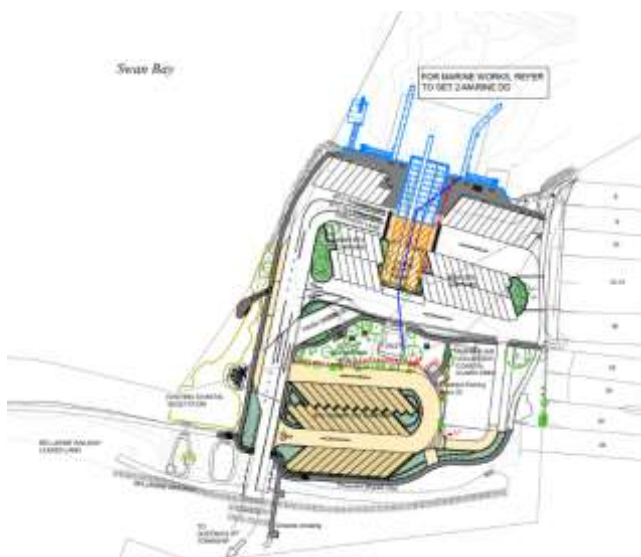

Frequently Asked Questions

Will I be able to use the boat ramp when construction is taking place?

No, once works begin there will be no access to the boat ramp. Works are due to commence in mid-June and the facility will be open again in early September.

Where can I launch and retrieve my boat while the Queenscliff boat ramp is closed?

The nearest boat ramps include St Leonards and Indented Head. For more information on local boat ramps please visit <https://www.boating.vic.gov.au> or <https://geelongaustralia.com.au/boating>

Why is the third boat ramp lane not being constructed this Winter?

The preparation of the pre-cast concrete panels for the boat ramp takes a long time. We don't want to risk impacting the spring fishing season and will be completing this next year. We will work to ensure the closure is minimised wherever possible and that prior warning is advertised before works commence.

Is dredging required at the boat ramp?

Yes, we will need to dredge approx. 3200m³ of silty sand that has accumulated in the immediate area around the boat ramp to provide all-tide access.

Where will the dredged sediment be disposed?

The sediment will be disposed of in line with Marine and Coastal Act 2018 and EPA regulations on Sand Island.

Will I still be able to use the bike/foot path?

Once construction has commenced a site fence will be established to limit public access to the works area. However, the bike/foot path will be diverted safely around the site compound and clearly signposted.

Is a fish cleaning table being constructed?

Not at the moment. A preferred location for a fish cleaning table was been identified next to the public toilets in the concept plan. The Victorian Fisheries Authority will be consulting with the public on designs and options before progressing next steps.

How will the upgrade improve congestion issues in Queenscliff?

An additional ramp lane, a central pontoon and widening all ramp lanes to 4 metres will facilitate more efficient launching and retrieval. In addition, we've added a dedicated boat rigging lane and added lane marking to improve circulation. This will increase the efficiency at which traffic flows and vessels can be launched and retrieved, reducing queuing. A web cam will be installed for the upgraded car park to advise users on current parking capacity.

Is the coast guard going to be disrupted by construction works?

No, the coast guard operations will be re-located to Queenscliff Harbor during construction works.

Will we get regular updates to let us know how the project is progressing?

Monthly updates will be provided on the Borough of Queenscliffe's website:

<https://www.queenscliffe.vic.gov.au/Home>

For more FAQs and updated information please go to: <https://betterboating.vic.gov.au/ramp-upgrades/queenscliff/>

Need more information?

Find out more about the government's recreational boating initiatives at www.betterboating.vic.gov.au

