

Swan Bay lookout

Incorporation of a lookout to the western side of the carpark to provide panoramic views over Swan Bay. The inspiration for the interpretation shape and character of the lookout has been drawn from the Southern Calamari (Squid) *Sepioteuthis australis*, a common marine creature residing in Swan Bay, also popular with fishers.

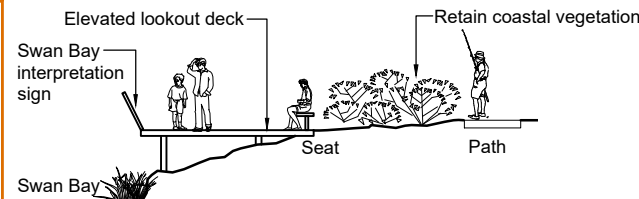

Section through lookout (Section A-A)

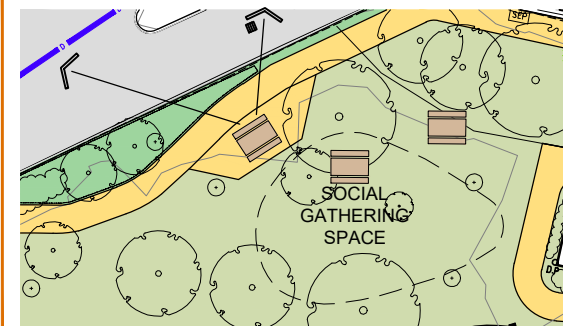

Social gathering space

Provision of a social seating area south of the washdown under the existing trees to encourage social gatherings and interactions by fishers and the public. Picnic seating arrangements have been arranged to capture different views and offers sun and shade seating.

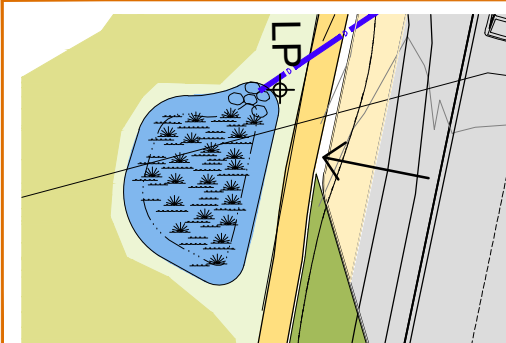

Water quality treatment wetland

Water Sensitive Urban Design (WSUD) pollution control water treatment wetland receiving water and pollution from the boat washdown facility and protecting Swan Bay.

DRAWING KEY

- Existing asphalt surfaces
- Proposed sand coloured asphalt
- Proposed concrete surfaces
- Proposed permeable paving
- Proposed grass
- Proposed garden bed
- Proposed wetland
- Proposed shared pathway
- Proposed mesh decking
- Proposed post and rail fence
- Proposed vehicular gates
- Existing coastal alkaline shrub
- Existing trees
- No vehicle standing ramp launch zone.
- Slightly raised area at top of boat ramp.

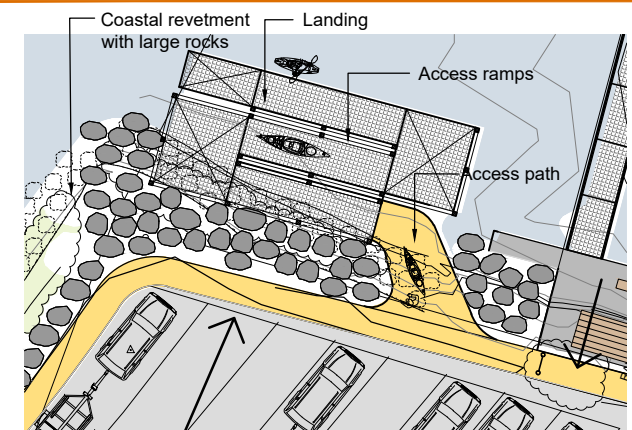
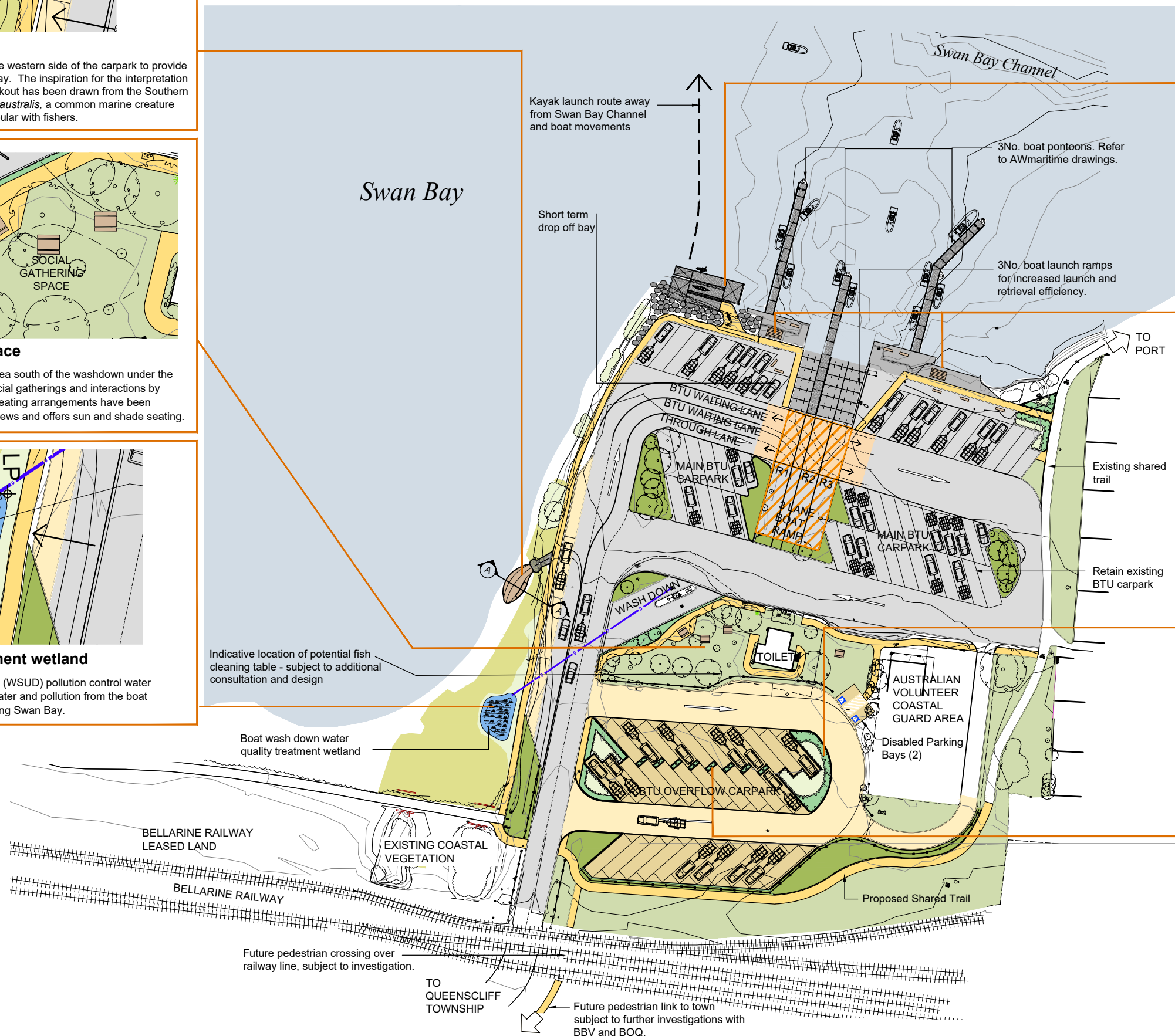

Kayak / canoe launch facility

Inclusion of a non-powered watercraft (kayak/canoe) launch facility to the north western side of the existing carpark situated away from motorised watercraft with a direct entry into Swan Bay. Including off-loading and short-stay bays.

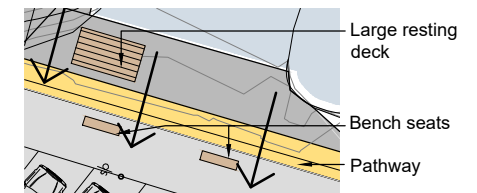

Large resting decks

Installation of large resting decks allowing for small groups to gather or allow the off-ground rigging of kayaks/canoes. Installation of bench seats north of the BTU parking bays overlooking the water

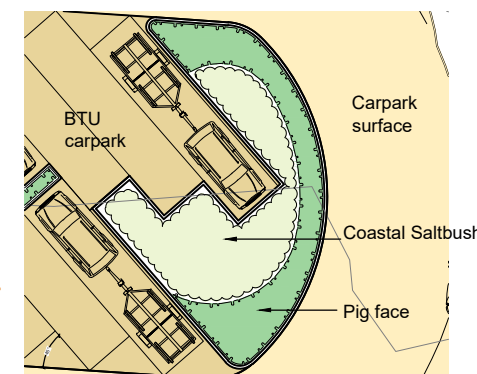

Typical carpark garden bed

Addition of several new garden beds to Queenscliff boat ramp carpark with indigenous coastal ground covers.

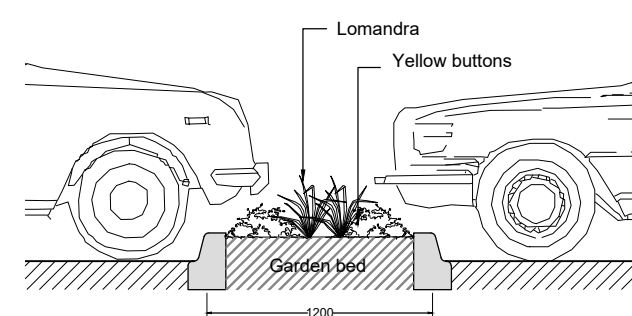

Raised parking bay bed in carpark

Carpark traffic safety improvement with the addition of raised garden bed islands preventing drive-through by vehicles.